

**LEGENDS:**

	UPRIGHT SPRINKLER HEAD, K-80, 68C, SR, 1/2" NPT
	EXTERNAL / INTERNAL SINGLE HEAD FIRE HYDRANT VALVE
	EXTERNAL FIRE HYDRANT HOSE CABINET COMPLETE WITH 2 NOS #65x7.5M LONG FIRE HOSE WITH COUPLING AND 1 NO #65 BRANCH PIPE JET NOZZLE
	INTERNAL FIRE ESCAPE HYDRANT HOSE CABINET COMPLETE WITH 2 NOS #65x7.5M LONG FIRE HOSE WITH COUPLING AND 1 NO #65 BRANCH PIPE JET NOZZLE
	FIRST AID FIRE HOSE REEL WITH 19mm X 30 Mtr HOSE WITH JET/SPRAY MULTIPURPOSE NOZZLE
	4.5 KG CO2 FIRE EXTINGUISHER
	6 KG DRY POWDER FIRE EXTINGUISHER
	50 LITRS FOAM FIRE EXTINGUISHER (TROLLEY TYPE)
	22 KG CO2 FIRE EXTINGUISHER (TROLLEY TYPE)
	ALARM CHECK VALVE
	ZONE CONTROL VALVE ASSEMBLY COMPLETE WITH LEVER OPERATED BUTTERFLY VALVE WATER FLOW DETECTOR (FOR FUTURE) PRESSURE GAUGE AND DRAIN BALL VALVE
	4-WAY X #150MM FIRE BRIGADE INLET
	WATER TYPE BUTTERFLY VALVE
	WATER TYPE/ BALL TYPE NON RETURN VALVE
	C/CHROME FINISH BALL VALVE
	BRONZE / FORCED BRASS GATE VALVE
	AIR RELEASE VALVE
	NEEDLE VALVE / BALL VALVE
	PRESSURE SWITCH

**PROPOSED FIRE HYDRANT & SPRINKLER PUMP SETS CONSISTS OF**  
 1 No. OF ELECTRIC DRIVEN JOCKEY PUMP  
 10.8 cu.m/hr @ 70 Mtrs HEAD CAPACITY  
 1 No. OF ELECTRIC DRIVEN MAIN PUMP  
 137 cu.m/hr @ 70 Mtrs HEAD CAPACITY  
 1 No. OF DIESEL ENGINE DRIVEN STANDBY PUMP  
 137.0 cu.m/hr @ 70 Mtrs HEAD CAPACITY  
 WITH REQUIRED AIR VESSEL TANK, PRESSURE SETTING MANIFOLD & TEST/DRAIN ARRANGEMENTS

**CONTROL PANEL FOR FIRE PUMP SETS WITH MAIN INCOMER & DISTRIBUTION AS BELOW**  
 FOR ELECTRIC DRIVEN JOCKEY PUMP SET  
 AUTO START/STOP & MANUAL START/STOP  
 FOR ELECTRIC DRIVEN MAIN PUMP SET  
 AUTO START & MANUAL START/STOP  
 FOR DIESEL ENGINE DRIVEN STANDBY PUMP SET  
 AUTO START & MANUAL START/STOP  
 CHARGING CIRCUIT FOR BATTERY  
 INTERNAL HOOTER

**ABBREVIATIONS :**

ACV	ALARM CHECK VALVE	U/G	UNDER GROUND
ARY	AIR RELEASE VALVE	A/G	ABOVE GROUND
F/B	FROM BELOW	F/A	FROM ABOVE
T/B	TO BELOW	T/A	TO ABOVE
WSP	WATER SPRAY LINE	QB	QUARTZOID BULB
WRP	WET RISER PIPE	SRP	SPRINKLER RISER PIPE

0	02.08.17	ISSUED FOR APPROVAL	MS	CVL	CS
		DESCRIPTION			

**PROJECT:** CANARA BANK CIRCLE OFFICE  
 MOUNT ROAD, ANNA SALAI, CHENNAI - 2

DESIGNED	MS	DATE	DRG. NO.
CHECKED	CVL		IFEC-17/CB/FF-01
APPROVED	CS		

RELEASED FOR  PRELIMINARY  TENDER  INFORMATION  APPROVAL  CONSTRUCTION

**CLIENT:**  
  
 Canara Bank

**FIRE ENGINEERING CONSULTANT:**  
 INTERNATIONAL FIRE ENGINEERING CONSULTANTS  
 SERVING FOR THE SAFETY OF LIFE, PROPERTY, COMMUNITY & ENVIRONMENT  
 VIRUGAMBANKKAM, CHENNAI - 600 092, INDIA.  
 Ph: +91 44 2364 2799, Fax: +91 44 2401 8860, Mob: +91 9751 949464  
 E-Mail: ifec.in@gmail.com / engineering@ifec.in, Web: www.ifec.in

**TITLE:** FIRE HYDRANT & SPRINKLER SYSTEM  
 EXTERNAL & GROUND FLOOR LAYOUT

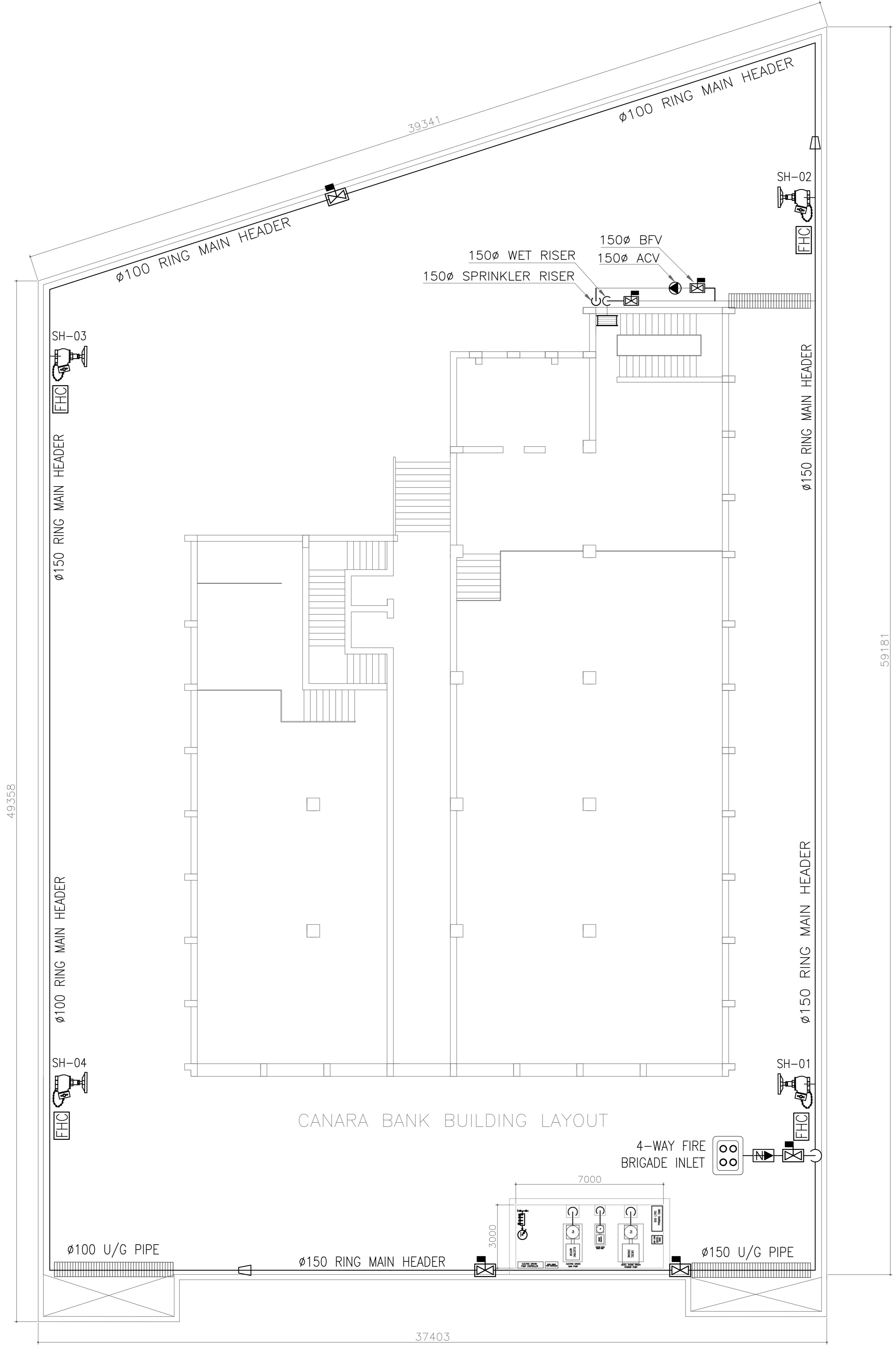

**SITE SETTING OUT & EXTERNAL FIRE HYDRANT LAYOUT**

59181